

SEG*superstand*
automatic parking stand

User and Installation Manual

www.segsuperstand.com

Safety first!

Safety Advices

1) Attention - Unfold always completely!

Make always sure that the parking leg is unfolded completely to the final position and your **SEGWAY** has arrived to a firm declined position.

2) Attention - SEGWAY load balance shall always be on front side!

If your **SEGWAY** is loaded with cargo, so that its balance is more to the backside, you can not use **SEGsuperstand** for safe parking! In that case you must allocate your **SEGWAY** by other means. (e.G. **SEGWAY X2 Golf**, parking on the golf bag)

3) Attention - Never parking on uneven ground!

Make sure that your **SEGWAY** always is parked on plain and even ground. **SEGsuperstand** is keeping your **SEGWAY** upright position, but is not allocating against running downhill. Consider that your **SEGWAY**'s bodyweight is making it running downhill everywhere. Blocking the achsle is not inside the function of **SEGsuperstand**.

4) Attention - Heavy loaded front bag may cause tumbling of your SEGWAY

If your **SEGWAY** front bag is loaded with heavy cargo (more than 5-6 kg; 12-14 pounds), there might be the risk of tumbling of your **SEGWAY**, crossing over your **SEGsuperstand** leg.

There for please always take off your heavy loaded font bag, while you are parking your **SEGWAY** using the **SEGsuperstand**.

The advantage of automatic folding in, obligatory needs a short leg construction of your **SEGsuperstand**, for that it is impossible to carry heavy overbalanced front loads during parking. We hope you understand the big advantage in automatic folding in for your daily safety and consider this with priority.

5) Attention - Do not move your SEGWAY while on parking leg

If you like to move your **SEGWAY** from one to another parking position, do not move while resting on the unfolded parking leg. Always let your **SEGsuperstand** being folded in before moving your **SEGWAY** to another place. Even for a few inches move let it automatically fold in and push the lever again after reaching the new parking position. Moving or pushing asife while being parked can cause damages to your **SEGsuperstand**. Any damages resulting from doing so will not be regulated under warrantee.

6) Attention - Never climb on the parked SEGWAY

While parked on **SEGsuperstand** it is not allowed to climb on your **SEGWAY**. Your **SEGsuperstand** is designed to carry the **SEGWAY** itself and its loading, but not the drivers weight. Climbing the **SEGWAY** in parking position can cause damages to your **SEGsuperstand**. Any damages resulting from doing so will not be regulated under warrantee.

7) Attention - Use with normal or hard boots only

Please use your **SEGsuperstand** only with normal or hard shoes. The push lever is dressed on the top surface with a rigid and sharp surface design in order to grant a good grip towards the drivers shoe sole.

Attention; In case of barefeet usage or with very light shoes there could be damages on the shoes or injuries to your skin. Therefore do not touch or release the push lever with your fingers.

8) Warning:



During Installation of youe **SEGsuperstand** ther might happen injuries to hands and fingers, caused by the spring powered folding in mechanism. Take always care to keep tightened the parking leg, while it is folded out.

9) Attention - Install SEGsuperstand on original SEGWAY PT only

SEGsuperstand PT i2 and **PT x2** are designed to be installed only on original **SEGWAY PT i2** or **x2**. Make sure that your **SEGsuperstand** model is named according to your **SEGWAY** model. Turn down the push lever and you can see the **SEGsuperstand** name tag.

SEGWAY is a registered trademark of **SEGWAY INC**, Bedford, USA.



For damages caused by not attending above mentioned security advices or other not correct usage of your **SEGsuperstand** the producer will not accept to be hold responsible at all.

Installation

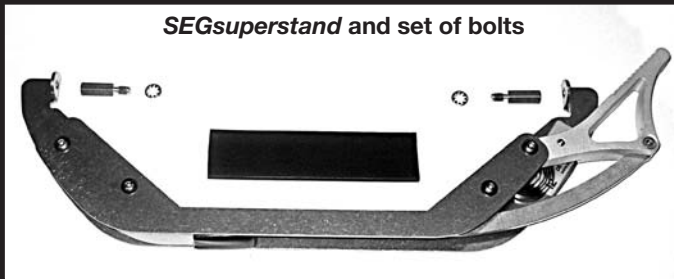

Required Tools

To install **SEGsuperstand** you need the following items:

- 1 pc. Allen key Screwdriver 4 mm (metric; long handle version)
- 1 pc. Hexagon Screwdriver 8 mm (metric)

Scope of Supply

- 1 pc. **SEGsuperstand**
- 2 pc. Hexagonal bolt M5 x 20 mm
- 2 pc. Stopp washer M5
- 1 pc. Rubber strip, adhesive, 120 mm x 30 mm

How to install

1. Turn your **SEGWAY PT** down to lay on the left wheel. The right wheel shall be now in top position. **SEGsuperstand** is always mounted on the right side in driving direction.
2. Between battery and right wheel you can not see the black bottom side of the gear box. (black and polished surface) Please clean the surface with a wet tissue or some glass cleaner, so that it is free of fat and dirt.
3. Now remove the paper cover from the adhesive rubber strip and fix the rubber strip on the gearbox surface. The rubber shall fit perfect to the edge of the gearbox in direction to the wheel. On top of that rubber you will later place the **SEGsuperstand**.
4. Remove now with the 4 mm allen key screwdriver the front and backside screw of the plastic **SEGWAY** body cover. You will find this screw between fender and platform on front and backside of your **SEGWAY**. Keep those screws carefully, as the **SEGsuperstand** is mounted later on with those screws.



5. Place now on the same position, where those screws has been taken off, each one hexagonal bolt M5 together with stop washer. The bolt is dressed with stop material on the thread, so please fix carefully to hold and do not loosen it within few hours. The stop material needs a time to harden. There should now be on former place of the screws each side one bolt usable as screw terminal for your **SEGsuperstand**. (front and backside between fender and platform)

6. **SEGsuperstand** has a front side (where the leg is folding out) and a back side (where the push lever is mounted). Make sure you recognize front and backside and place now your **SEGsuperstand** from the **SEGWAY** bottom side in that space, left between battery and right wheel. Your **SEGsuperstand** shall now arrive on top of the rubber strip mounted before. Its screw points shall reach near to the screw terminals (bolts) placed before.
7. Now fix your **SEGsuperstand** at first with the screw on the backside terminal. Do not fix to strong, as you need to place the front one first. (Important: Back side first is important as you need to use the unfolded leg as handle to reach the final mounting position against the rubbers elastic force)



8. Make sure that your **SEGWAY** is firmly allocated and can not turn. Take a position so that you easily can place the front screw to the front terminal. Unfold the parking leg and use it as strong handle to press your **SEGsuperstand** firmly to the rubber strip. With good effort you should reach a position, where the front screw can be placed easily and fixed. Please check again, that your **SEGsuperstand** is still with both sides on top of the rubber strip (on top of the gearbox) and not slipped over aside. If so please tighten both screws finally. Use **SEGWAY** original screws only (with elastic stop material on the thread).

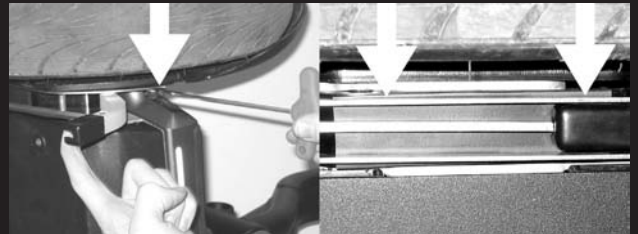

Attention: The parking leg is folding in automatically, danger to hurt your finger!!

9. Please check now multiple times the unfolding and folding of the parking leg. As consequence of long transportation or warehousing the mechanic could hang a bit. Passing some cycles of moving out and in and all parts will come back to easy motion. This could also happen after long parking period without use. Just moving a little and function shall be there.
10. Your installation is finalized. Please read the users manual and the security advice carefully.

For detailed photos please see end of documentation.

Users Manual

1. *SEGsuperstand* in driving position

During driving your *SEGsuperstand* will remain folded between fender and battery cover.

It is slightly bigger than the batteries bottom cover, but there is no sharp edge or handle delimit your **SEGWAYs** space over ground.

On the backside the push lever is placed near to platform level, so that it is easy to reach, but not exceeding the **SEGWAYs** original dimensions. So you can pass your **SEGWAY** stairs up and down as before, without any mechanical interference with your new *SEGsuperstand*.

Attention: Changed wheel types with non original diameter could cause the handles stand-over.

During drive the parking leg should be always folded in and in stand-by position, kept firmly on the rubber striped gearbox body.

2. *SEGsuperstand* in parking position

During parking position the *SEGsuperstands* parking leg is unfolded and will keep your **SEGWAY** safe in upright position on plain grounds. You **SEGWAY** is kept in an declined position to reach stability and the red warning lamp, so that the balance mode can not be activated. This can change if you will park your **SEGWAY** on uneven ground.

In case that a driver climb on in parking position, the red lamp shall cause alarm and get vibratory and noisy alert out of the **SEGWAYs** electronic.

3. Starting from park position

Pick up the steering as usual and bring it to horizontal position in order to activate the balance mode. About the same moment of ignition of the **SEGWAYs** green signal lamp, your *SEGsuperstand* shall fold in his parking leg automatically. Uneven ground or parking in not plain area could hinder, so always check the fold in process and make sure the push lever is returning to its up most position. In the seldom case of not folding in you can easy help with your shoe tip to make the push lever move upwards. Now you're ready to start riding your **SEGWAY**.

4. Parking your **SEGWAY**

Step down from the **SEGWAYs** platform and wait until the beep signalize that you can deactivate the balance mode. Deactivate it by a short push on the ON/OFF swith or change for security mode or switch-off completely.

Only after deactivation of balance mode or fully switched-off **SEGWAY** you can use you *SEGsuperstand* for parking. Push down the push lever on the backside until the parking leg is unfolding to its outmost position. Make sure that this position is reached and release the steering of your **SEGWAY** so that the **SEGWAY** body comes to rest safely on the parking leg.

Always make sure that the **SEGWAYs** is settled down on the parking leg firmly.

5. Clean and service your *SEGsuperstand*

Your *SEGsuperstand* is mainly made from stainless steel and Aluminium, so it is quite robust against environmental conditions. All bearings are complete grease free longlife runner and need no service at all. Just keep you *SEGsuperstand* clean with water and soft detergents. So that no dirt can block the mechanical functions. That's all!

6. Warrantee

The producer grants 12 month warrantee on all components of *SEGsuperstand*. Date of purchase on authorized dealers invoice is binding. The rubber cap is a consumable and not covered by this warranty. All damages caused by violation of the security advices or non appropriate use is automatically cancelling all producers warrantee regulation. In those cases customer receives a cost projection in order to decide about repair on his own cost. (See Security Advices, Pos. 4 and 5)

The latest hints about installation and handling can be found at www.segsuperstand.com



Attention!! Careful study of all Security advices is mandatory!!



SEGWAY auf die linke Seite legen
Turn your SEGWAY down on the left side



Gummi fixieren / Schrauben lösen
Fix rubber stripe / remove screws



Je 1 Bolzen mit Zahnring einschrauben
Place each side hexagonal bolt with washer



Zuerst hinten den SEGsuperstand befestigen
Fixt first SEGsuperstand with backside screw



Fuß als Hebel benutzen / festschrauben vorn
Press parking leg while fixing front screw

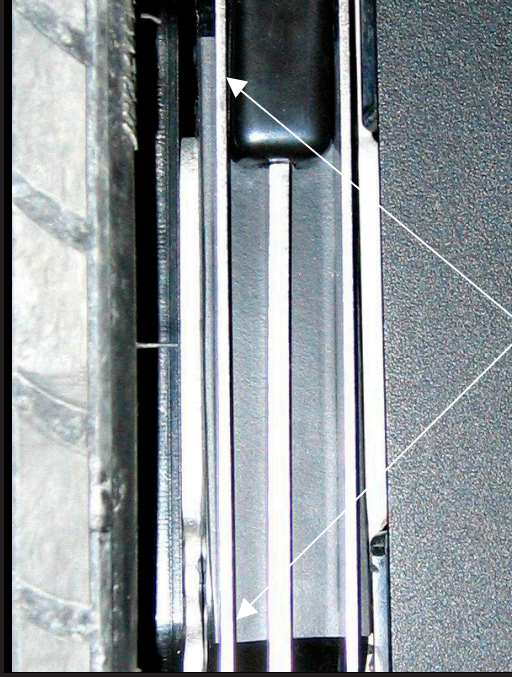

Seitentail muss kpl. auf Gummi aufliegen
Make sure position is complete on the rubber